

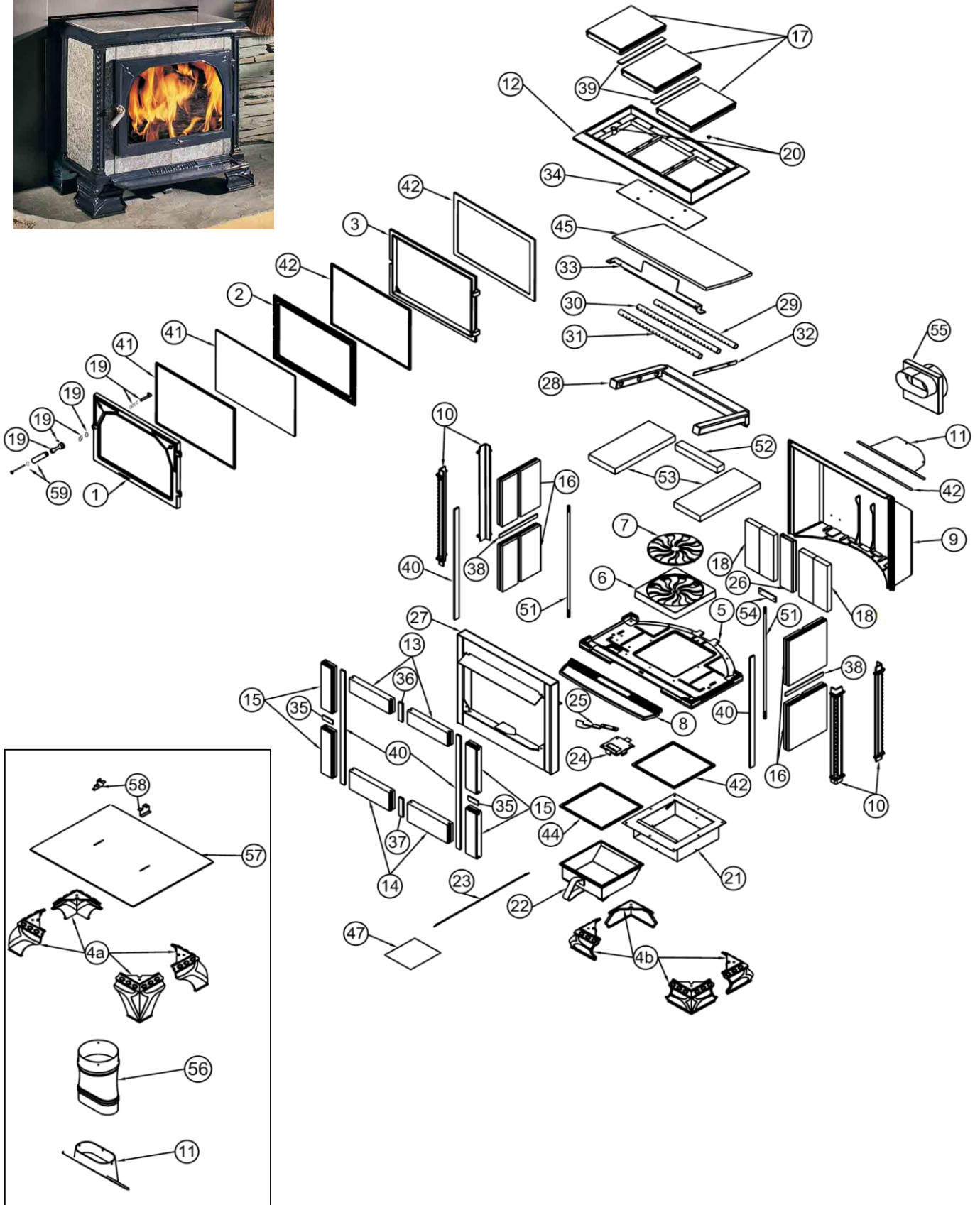

Homestead Model 8570



Free Standing

主要パーツ

Key	Part #	Description	定価 (税別)
	3110-057	ガスケット: フロントドア用 3/8"Low (9.5)	160cm 1,100/m
	3110-059	ガスケット: 灰受けドア用 3/8"Med (9.5)	110cm 1,100/m
	3160-080	ガスケット: ガラス用 フラット(テープ付)3/4"(19)	150cm 1,500/m
45	3120-920	バップル(セラミック):ホームステッド8570	27,400
7	2510-730	グレート:ホームステッド8570 (Φ232)	16,100
41	90-57005	ガラスキット: マンスフィールド8011/8012/ホームステッド (284x445, t5)	43,800
* ガラス用ガスケット(3160-080) が含まれます。			

Key	Part #	Description	定価 (税別)
1	2010-500	DOOR: FRONT, MATTE, MAN/HER/HOM	
2	2010-550	FRAME: GLASS RETAINER, MAN/HER/HOM	22,100
3	2010-602	FRAME: DOOR, FRONT, OUTER, MAT, MAN/HER/HOM	40,700
4a	2510-705	FOOT: LONG, MATTE, HOM	13,800
4b	2510-700	FOOT: SHORT, MATTE, HOM	
5	2510-710	BOTTOM: MATTE, HOM	75,600
6	9510-720	Ash Grate Frame	
7	2510-730	GRATE: ASH, HOM	グレート 16,100
8	2510-741	ASH LIP: NO LOGO, MATTE, HOM	32,600
9	2510-750	PANEL: REAR, HOM	134,400
10	2510-760	LEG: SIDE, MATTE, HOM	18,500
11	2510-770	COLLAR: FLUE, OVAL, HOM	40,800
12	2510-780	TOP: MATTE, HOM	97,600
13	1141-251	STONE: POL, 2-3/4"x9-1/2", FT/FB, MAN/HER	9,800
14	1141-252	STONE: POL, 3-3/4"x9-1/2", FB/FT, MAN/HE	8,500
15	1141-253	STONE: POL, 2-19/32"x9-1/2", SLOT, FS, HE	9,500
16	1541-730	STONE: POL, 8-7/8"x9-3/8", S, HOM	13,400
17	1541-780	STONE: POL, 8"x10-1/2", T, HOM	27,600
18	95-83700	FIREBRICK: REAR (WITH SPACER), HOM	11,100
	3060-430	FIREBRICK: 3-7/8"x9"x1-1/4	5,600
	5957-000	SPACER: BRICK, HOM	3,400
Replaces Firebrick: 8 3/32"x9 7/8"x1 1/4" (one on each side)			
19	90-73112	LATCH: FRONT DOOR, COIL SPRNG, MAN/HER/HOM	フロントドアラッチキット 12,600
	4500-2976	SCREW: SET, 5/16-18x3/8", HALF DOG, SOCKE	800
	4700-0790	SPACER: DOOR LATCH, 0.435"x0.375"x0.03"	400
	5010-081	CRANK: HANDLE, WOOD STOVES	5,200
	5240-138	SPRING: LATCH, WOOD STOVES, 325#	2,500
	5010-078	LATCH: DR, FRT, SPRING, GROOVE, MAN1, HOM (Dens	6,600
	5021-032	WASHER: FLAT, .406"IDx1"ODx.035"T, BLK	600
20	4200-0410	NUT: TAMPER-RESISTANT, 3/8-16, ZN	1,600
21	5570-010	BOX: ASH PAN, HOM	42,400
22	95-54700	ASH PAN: HOM	41,500
	5570-020	PAN: ASH, HOM	65,300
	3110-059	GASKET: ROPE, 3/8", MED DEN, BLK	1,100/m
23	5570-030	CABLE: LABEL, 1/16"Dx12", 2 EYES, HOM/DV	
24	5570-040	SLIDE: PRIMARY AIR CONTROL, HOM	23,800
25	5570-050	ROD: AIR CONTROL, PWD COAT, HOM	7,100
26	5570-070	PIPE: AIR, SECONDARY, RISER, HOM	13,500
27	5570-080	PLENUM: AIR, PRIMARY, HOM	98,100
28	5570-110	PLENUM: AIR, SECONDARY, HOM	68,800
29	5570-121	PIPE: AIR, SECONDARY, #1, HOM	18,000
30	5570-122	PIPE: AIR, SECONDARY, #2, HOM	18,000
31	5570-123	PIPE: AIR, SECONDARY, #3, HOM	18,000
32	5570-130	BRACKET: LOCK, SECONDARY AIR PIPES, HOM	8,800
33	5570-140	SUPPORT: BAFFLE, HOM	43,200

Key	Part #	Description		
34	5570-150	HEATSHIELD: TOP,SS,HOM/HER 1		11,100
35	5000-001	SPLINE: 1/8"x3/4"x1-1/4		1,400
36	5000-002	SPLINE: 1/8"x3/4"x2-1/2		1,400
37	5000-003	Spline: 1/8"x3/4"x3-1/4"		
38	5000-009	SPLINE: 1/8"x3/4"x8-1/8		3,100
39	5000-013	Spline: 1/8"x3/4"x10-3/8"		
40	5000-2236C	SPLINE: 1/8"x3/4"x18-3/4		5,800
41	90-57005	GLASS: MAN/HER/HOM	ガラスキット	43,800
45	3120-920	BOARD: CERAMIC,11.54 x 21.69 x1/2",HOM	バップル	27,400
51	5210-2330	ROD: THREAD,3/8-16x20.5",0.31"&2",H		3,400
52	1-0500-700	STONE: REF,1-1/2"x9-3/4",HOM		5,000
53	1-0500-701	STONE: REF,5-1/2"x11-1/4",HOM		12,300
54	5570-075	STRAP: RISER PIPE,SECONDARY AIR,HOM		3,600
55	5700-710	PIPE:VENT,ADAPT,OVAL/RD,SHORT,SS,BLK,HOM		
56	5700-705	PIPE:VENT,ADAPTOR,OVL/RD,BLACK,LG,HOM		
57	5930-2005	HEATSHIELD: BOTTOM,HOM		17,500
58	5930-2006	BRACKET: BOTTOM HEATSHIELD,HOM		4,700
59	90-71100	HANDLE: DOOR,WOOD STOVES	ハンドルキット	4,500
	3900-177	HANDLE: WOOD,BLACK		4,100
	4500-1680	SCREW: MACH,1/4-20x3-1/4",ROUND,SLOT,Z		1,600
	4600-0400	WASHER: LOCK,1/4,SPLIT,MED,ZN		400

※廃番機種のパーツは、主要パーツ以外、在庫がなくなり次第終了となります。

Hardware		QTY.	定価(税別)
Stove Body			
3110-056	Gasket: Rope, Bottom Casting Channels, 1/4", AD	3.5 ft	900/m
4500-2114	Screw: Ash Pan to Btm Casting, 10-24x3/8", F, Pan, PH, Blk Ox	7	400
4500-1910	Screw: Center Front hole for Above, 10-24x1/2", Flat, PH, Blk	1	400
4500-1876	Screw: Pri. Air Control Slide Retention, 10-24x1/2", Pan, PH, ZN	4	400
4100-0280	Screw: Pri. Air Rod to Bottom, Shoulder, 5/16"Dx1/4"L, Socket	1	800
4600-1400	Washer: Wave, For Above, 5/16, 0.030"	1	1,400
5570-060	Washer: For Above, Slide Arm	1	1,600
4500-3435	Screw: Bottom Heat Shield Bracket to Btm Cast, 8-32x3/8", F, PH	2	400
4500-3200	Screw: Foot to Btm Cast, 5/16"-18x1", Hex, ZN, Gr 2	4	400
4600-0850	Washer: Lock for Above, 5/16", Split, Zn	4	400
4600-0300	Washer: Flat, for Above, 1/4", Blk Ox	4	600
4100-0115	Bolt: Rear Panel to Btm Cast, Carriage, 1/4"-20x1", Ribbed	4	
4600-0400	Washer: Lock for Above, 1/4", Split, Zn	4	400
4200-0200	Nut: Finishing, For Above, 1/4"-20, Hex, ZN	4	400
4500-3436	Screw: Secnd. Air Riser Retn. Strap to Rear Panel, 10-24x3/8"	2	400
3160-392	Gasket: Flat, Front Door Frame to Stone, 3/8"x1/8"	5.3 ft	1200/m
4500-1360	Screw: Front Door Frame to Pri. Plenum, 1/4"-20x1-1/2", Flat, PH,	4	600
4300-0110	Pin: Cotter, Baffle Support to Secnd. Air Plenum, 1/8"x1-1/2", SS	1	800
4500-0570	Screw: Top Heatshield to Top Cast, 1/4"-20x1/2", Hex, SS	4	800
3110-057	Gasket: Rope, Top Cast Channel, 3/8", AD	5.7 ft	1100/m
5210-2330	Rod: Top Cast to Btm Cast, Thread, 3/8"-16x20-1/2", 0.31"	2	3,400
4200-0410	Nut: For Above, Top, Tamper Resistant, 3/8"-16, ZN	2	1,600
4200-0400	Nut: For Above, Bottom, 3/8"-16, Finishing, Hex, ZN	2	600
4600-0700	Washer: Lock, For Above, 3/8", Split	2	400
3110-059	Gasket: Rope, Ash Pan, 3/8" Med Den	3.5 ft	1100/m
3110-056	Gasket: Rope, Flue Collar Channel, 1/4", Ad	2.92 ft	900/m
4500-0400	Screw: Flue Collar to Rear Panel, 1/4"-20x3/4", Hex, ZN, Gr 2	4	600
4500-1100	Screw: Empty Holes Beside Flue Collar, 1/4"-20x1", Pan, PH, Blk	4	800
4500-3436	Screw: Empty Holes on Bottom of Rear Panel, 10-24x3/8"	4	400
Door			
4500-3430	Screw: Glass Retainer Frame to Door, 8-32x3/8", Flat, PH, Blk Ox	8	400
3110-057	Gasket: Rope, Glass Retainer Channel, 3/8", AD	5 ft	1100/m