

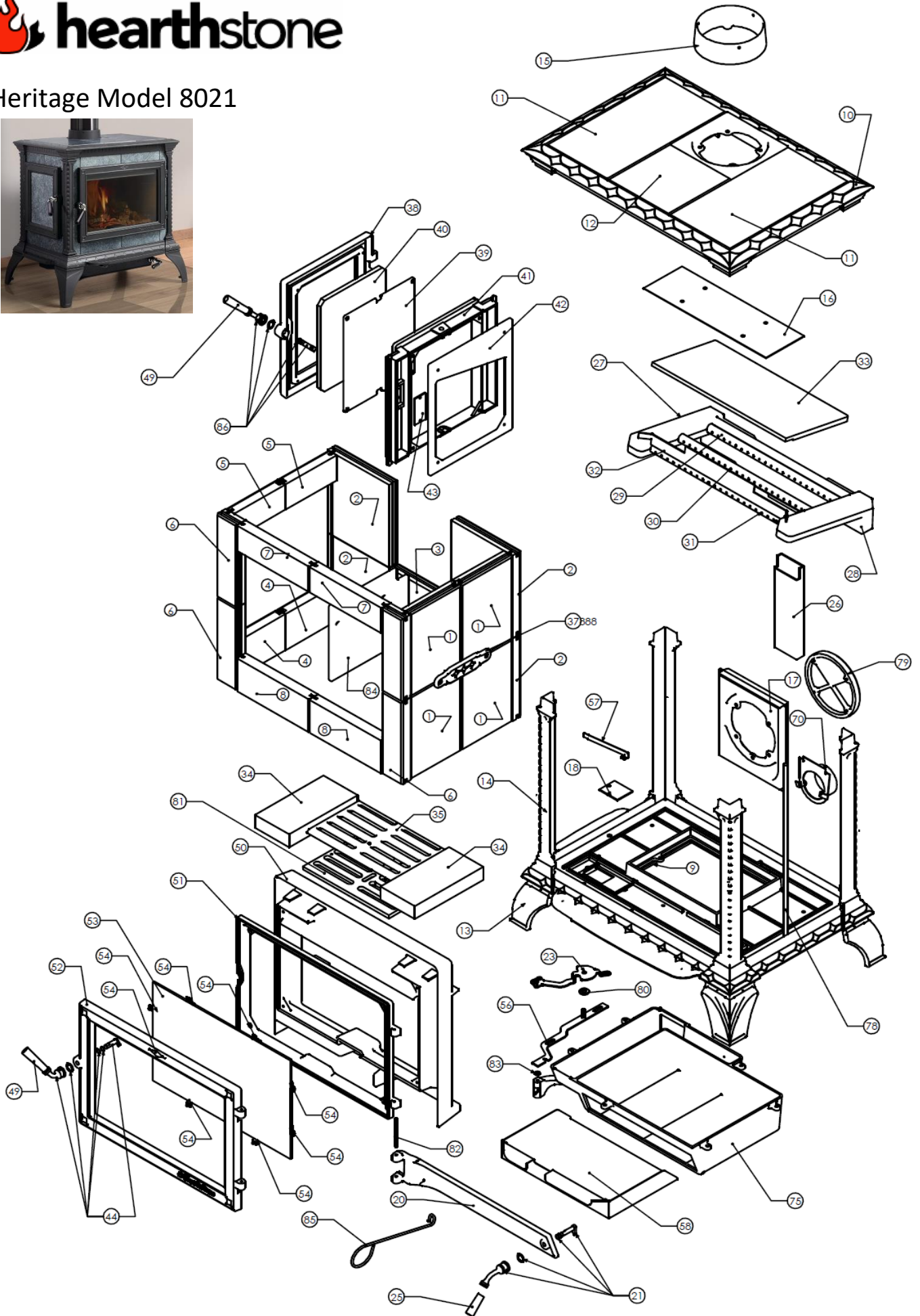

Heritage Model 8021



主要パーツ

Key	Part #	Description	定価(税別)		
	3110-059	ガasket: フロントドア用	3/8"Med (9.5)	180cm	1,100/m
	3110-059	ガasket: サイドドア用	3/8"Med (9.5)	120cm	1,100/m
	3110-059	ガasket: 灰受けドア用	3/8"Med (9.5)	90cm	1,100/m
	3110-056	ガasket: ガラス用	1/4"(6.4)	150cm	900/m
	3120-021	ガasket: ガラスクリップ用	セクション	8ヶ	400/ヶ
33	90-76230	バップルキット(セラミック):ヘリテージ8021/8022/8023共通			30,900
35	2010-228	グレート:ヘリテージ8021 (285x180)			19,400
53	90-58215	ガラスキット:ヘリテージ8021/8022/8023/8024共通 (287x457, t5)			46,900
* ガラスキットには、ガラス用ガasket、ガラスクリップ、ビス、ガラスクリップ用ガasketが含まれます。					

Key	Part #	Description	QTY.	定価(税別)
1	1421-56	STONE: POL,6-11/16"x9-1/2",S/,HER1/HA	4	21,700
2	1201-25	STONE: POL,8"x9-1/2",4 BEVEL,RS/,HER/	4	22,800
3	1201-26	STONE: POL,8"x9-1/2",RC/RC/,MAN/HER/H	1	22,800
4	1141-240	STONE: POL,4-5/32"x6-11/16",DB,HER 1	2	9,900
5	1141-242	STONE: POL,2-7/8"x6-11/16",DT,HER 1	2	7,900
6	1141-253	STONE: POL,2-19/32"x9-1/2",SLOT,FS,HE	4	9,500
7	1141-251	STONE: POL,2-3/4"x9-1/2",FT/FB,MAN/HER	2	9,800
8	1141-252	STONE: POL,3-3/4"x9-1/2",FB/FT,MAN/HE	2	8,500
9	2010-225	BOTTOM: MATTE,HER 1	1	122,300
10	2010-290	TOP: MATTE,HER 1	1	98,200
11	1141-243	STONE: POL,8" x 15-3/4",TS,HER 1	2	28,000
12	1141-261	STONE: POL,8-1/32"x8-3/32",TC,HER 1	1	23,400
13	2010-210	FOOT: MATTE,HER 1/TRI (SHORT)	4	15,800
	2010-310	FOOT:MATTE,HER 1/CAS/HER 2	4	26,100
14	2010-230	LEG: SIDE,MATTE,HER 1	4	42,400
15	2010-285	COLLAR: FLUE,MATTE,HER 1/TRI/MCR/CAS	1	26,100
16	5570-150	HEATSHIELD: TOP,SS,HOM/HER 1	1	11,100
17	2010-280	FRAME: FLUE,BACK,HER 1/CAS	1	45,700
18	5021-025	SLIDE: PRIMARY AIR CONTROL,HER 1/TRI	1	3,100
20/75	2010-216	SUB-ASSY: ASH PAN DOOR AND FRAME,HER 1	1	88,000
		Ash Pan Door (Old pt# 2010-220)	1	
		Ash Pan Frame (Old pt# 2010-216)	1	
		Pin: Cotter (Old pt# 4300-0150)	1	
		Pin: Clevis, Steel (Old pt# 4400-0550)	1	
21	90-73216	LATCH: ASH DOOR,SPRING&SHEATH,HER 1	アッシュドアラッチキット	24,100
	4500-2976	SCREW: SET,5/16-18x3/8",HALF DOG,SOCKE	1	800
	5021-012	CRANK: HANDLE,ASH DOOR,HER 1	1	10,500
	5240-135	SPRING: LATCH,ASH PAN DOOR,HER 1/BEN	1	3,300
	5021-053	LATCH:DOOR,ASH PAN,SPRG,GROV,HER1(DEINSA)	1	8,800
23	5021-030	HANDLE:PRI AIR CONTROL,PWD COAT,HER 1	1	9,000
25	90-71100	HANDLE: DOOR,WOOD STOVES	木製ハンドルキット	4,500
	3900-177	HANDLE: WOOD,BLACK	1	4,100
	4500-1680	SCREW: MACH,1/4-20x3-1/4",ROUND,SLOT,Z	1	1,600
	4600-0400	WASHER: LOCK,1/4,SPLIT,MED,ZN	3	400
26	5021-040	PIPE: AIR,SECONDARY,RISER,HER 1	1	14,900
27	2010-242	PLENUM: AIR,SECONDARY,TOP,HER 1	1	49,000
28	2010-240	PLENUM: AIR,SECONDARY,BOTTOM,HER 1	1	38,000
29	5021-041	PIPE: AIR,SECONDARY,#1,HER 1	1	19,000
30	5021-042	PIPE: AIR,SECONDARY,#2,HER 1	1	19,000
31	5021-043	PIPE: AIR,SECONDARY,#3,HER 1	1	19,000
32	5021-065	SUPPORT: BAFFLE,SS,HER 1	1	22,800

Key	Part #	Description	QTY.	
33	90-76230	パッフルキット(セラミック):ヘリテイジ8021/8022/8023共通		30,900
	3120-022	BOARD: CERAMIC,BAFFLE,HER2	1	
	4300-0120	PIN: COTTER,1/8x2",SS	2	800
	5022-014	BRACKET: BAFFLE,SS,HER2	1	9,900
34	1-0000-101	STONE: REF,4-1/2"x9"x1-1/4",MAN 1/HE		9,800
35	2010-228	GRATE: ASH,HER 1	1	19,400
37	2010-275	TRIM: SIDE,MATTE,HER 1/TRI	1	15,800
38	2010-250	DOOR: SIDE,MATTE,HER 1	1	35,700
39	2010-252	PLATE: STONE RETAINER,SIDE DOOR,HER 1	1	34,600
40	1141-241	STONE:POL,8-3/8"x10-1/4",SIDE DOOR,HE	1	25,900
41	2010-255	FRAME: DOOR,SIDE,OUTER,HER 1	1	31,900
42	2010-257	FRAME: DOOR,SIDE,INNER,HER 1	1	34,600
43	5021-055	PLATE: SIDE DOOR,OUTER FRAME,HER1	1	3,100
44	90-73212	LATCH: FRT DOOR,COIL SPNG,HER 1/TRI		フロントドアラッチキット 13,800
	4500-2976	SCREW: SET,5/16-18x3/8",HALF DOG,SOCKE	1	800
	4700-0790	SPACER: DOOR LATCH,0.435"x0.375"x0.03"	4	400
	5010-081	CRANK: HANDLE,WOOD STOVES	1	5,200
	5240-138	SPRING: LATCH,WOOD STOVES,325#	1	2,500
	5021-022	LATCH:DR,FRT,SINGLE BEV,HER1/TRI(Deinsa)	1	6,600
	5021-032	WASHER: FLAT,.406"IDx1"ODx.035"T,BLK	1	600
49	90-71100	HANDLE: DOOR,WOOD STOVES		木製ハンドルキット 4,500
	3900-177	HANDLE: WOOD,BLACK	1	4,100
	4500-1680	SCREW: MACH,1/4-20x3-1/4",ROUND,SLOT,Z	1	1,600
	4600-0400	WASHER: LOCK,1/4,SPLIT,MED,ZN	3	400
50	2010-245	PLENUM: AIR,PRIMARY,HER 1	1	71,800
51	90-85215	FRONT DOOR FRAME KIT: HER 1		フロントドアフレームキット 53,400
	4500-1359	SCREW: MACH,1/4-20x3/4",PAN,PH,BLK	4	1,000
	5021-056	STRIKER: FRONT DOOR FRAME,HER 1	1	6,900
	4500-3423	SCREW: MACH,8-32x1/4",UND-CUT,FLAT,PH,ZN	2	400
52	2010-270	DOOR: FRONT,MATTE,HER 1	1	40,700
53	90-58215	GLASS: HER 8021/8022/8023/8024		ガラスキット 46,900
	3030-038	GLASS: IR,11-5/16"x18"x5mm,HER 1	1	
	3110-056	GASKET: ROPE,1/4",BLK,AD	150cm	900/m
	3120-021	GASKET: GLASS CLIP, BLACK	8	400/ケ
54	5021-060	CLIP: GLASS,HER 1/TRI	8	1500/ケ
	4500-2105	Glass Clip Screw	8	400/ケ
56	5021-035	ARM: CONTROL,ASH GRATE,HER 1	1	13,600
57	5021-020	RETAINER: SLIDE,PRI AIR CONTROL,HER1/TRI	1	6,000
58	5021-010	PAN: ASH,HER 1	1	17,300
70	90-53210	OPTION - OUTSIDE AIR KIT: HER 1/CRA		
75		Ash Pan Frame (see 20 above)		
78	5210-2320	ROD: THREAD,3/8-16x21",0.31"&2",H	1	5,900
79	2010-282	PLATE: FLUE, HER 1/MCR/CAS	1	16,500
80	5550-155	BUSHING: SHUTTER,PRI AIR,1/4"x3/8",ST		4,700
81	2010-227	BASE: ASH GRATE,HER 1	1	26,100
82		Ash Door Hinge Pin (see 20 above)		
83	4600-0800	WASHER: FLAT,5/16,USS (7/8" OD),BLK ZN	9	400
84	2010-422	PLATE: SIDE,RIGHT,HER	1	25,000
85	5021-037	HANDLE: CONTROL,ASH GRATE,HER 1	1	6,900
86	90-73213	LATCH: SIDE DOOR,COIL SPNG,HER 1		サイドドアラッチキット 15,000
	4500-2976	SCREW: SET,5/16-18x3/8",HALF DOG,SOCKE	1	800
	4700-0790	SPACER: DOOR LATCH,0.435"x0.375"x0.03"	4	400
	5010-081	CRANK: HANDLE,WOOD STOVES	1	5,200
	5021-023	LATCH: DOOR,SIDE,SINGLE BEV,HER1(Deinsa)	1	8,800
	5021-032	WASHER: FLAT,.406"IDx1"ODx.035"T,BLK	1	600
	5240-138	SPRING: LATCH,WOOD STOVES,325#	1	2,500

※ 鑄鉄パーツのエナメルカラーは別途お問合せください。(ブラウンエナメル:20、ブラックエナメル:50、シーフォーム:61)

Hardware

	Part #	Description	QTY.	定価(税別)
Stove Body				
Ash Grate Base to Bottom Cast	4500-0570	SCREW: CAP,1/4-20x1/2",HEX,SS	2	800
Flat Washer for 4500-0570	4600-0300	WASHER: FLAT,1/4,USS,BLK OX (3/4" OD)	2	600
Ash Grate Control Handle to Ash Grate & Btm Cast	4100-0280	SCREW: SHOULDER,5/16"Dx1/4"L,SOCKET	2	800
Flat Washer for 4100-0280	4600-0300	WASHER: FLAT,1/4,USS,BLK OX (3/4" OD)	2	600
Primary Air Control Handle to Bottom Cast Mount	4500-0700	SCREW: CAP,1/4-20x5/8",HEX,GRADE 5,BL OX	1	400
Lock Washer for 4500-0700	4600-0400	WASHER: LOCK,1/4,SPLIT,MED,ZN	1	400
Piviot Bushing for 4500-0700	5550-155	BUSHING: SHUTTER,PRI AIR,1/4"x3/8",ST	1	4,700
Bottom Cast Channel Gasket	3110-057	GASKET: ROPE,3/8",AD,NON-CORE	87"	1100/m
Ash Pan Door Gasket	3110-059	GASKET: ROPE,3/8",MED DEN,BLK	36"	1100/m
Ash Pan to Bottom Casting	4500-0920	SCREW: T-CUT,1/4-20x1",F",HEX WASH,	6	800
Feet to Bottom Casting	4500-3220	SCREW: CAP,5/16-18x1-1/4",HEX,ZN,GR5	4	600
Lock Washer for 4500-3320	4600-0850	WASHER: LOCK,5/16,SPLIT,MED,ZN	4	400
Flat Washer for 4500-3320	4600-0800	WASHER: FLAT,5/16,USS (7/8" OD),BLK ZN	4	400
Primary Air Control Slide Retainer	4500-3436	SCREW: T-CUT,10-24x3/8,"F",PAN,PH,BLK	2	400
Side Door Plate to Side Door Frame	4500-3436	SCREW: T-CUT,10-24x3/8,"F",PAN,PH,BLK	2	400
Inner to Outter Side Door Frame	4500-0500	SCREW: MACH,1/4-20x3/4",FLAT,PH,BLK OX	4	400
Baffle Support/Baffle to Secondary Manifold	4300-0110	PIN: COTTER,1/8x1-1/2",SS	2	800
Front Door Frame to Stove Body Gasket	3160-392	GASKET:3/8"X 1/8"FLAT KNIT BLK 1/4"AD SP	5.5 ft.	1200/m
Front Door Frame to Primary Plenum	4500-1359	SCREW: MACH,1/4-20x3/4",PAN,PH,BLK	4	1,000
Top Casting to Bottom Casting Rods	5210-2320	ROD: THREAD,3/8-16x21",0.31"&2",H	1	5,900
Conical Nut for 5210-2320	4200-0410	NUT: TAMPER-RESISTANT,3/8-16,ZN	1	1,600
Finishing Nut for 5210-2320	4200-0400	NUT: FINISHING,3/8-16,HEX,ZN	1	600
Outside Door Frame Top to Top Cast	4500-2855	Screw: 3/8-6x4", Hex, ZN, Gr 5 4500-2855	1	600
Tamper Resistant Nut for 4500-2855	4200-0410	NUT: TAMPER-RESISTANT,3/8-16,ZN	1	1,600
Outside Door Frame Bottom to Bottom Cast	4200-2910	Screw: 3/8-16x6", Hex, ZN, Gr 5 4200-290	1	
Finishing Nut for 4200-2910	4200-0400	NUT: FINISHING,3/8-16,HEX,ZN	1	600
Lock Washer for 4200-2910	4600-0700	WASHER: LOCK,3/8,SPLIT,MED	1	400
Side Rondel to Inner Strike Plate	4500-1420	SCREW: SHCS,LOW,1/4-20X2 1/2",BL OX	2	2,000
Fininshing Nut for 4500-1420	4200-0200	NUT: FINISHING,1/4-20,HEX,ZN	2	400
Flat Washer for 4500-1420	4600-0300	WASHER: FLAT,1/4,USS,BLK OX (3/4" OD)	2	600
Secondary Manifold to Rear Flue Plate	4500-1420	SCREW: SHCS,LOW,1/4-20X2 1/2",BL OX	1	2,000
Flat Washer for 4500-1420	4600-0300	WASHER: FLAT,1/4,USS,BLK OX (3/4" OD)	1	600
Top Casting Stone Channel	3110-057	GASKET: ROPE,3/8",AD,NON-CORE	6.7 Ft.	1100/m
Rear Heat Shield to Top Cast	4500-0570	SCREW: CAP,1/4-20x1/2",HEX,SS	4	800
Flue Collar Gasket	3110-056	GASKET: ROPE,1/4",BLK,AD	3.2 ft.	900/m
Flue Collar Stud	4500-1351	STUD: 1/4-20x1-1/2",FULLY THREADED,SS	4	1,200
Finishing Nut for 4500-1351	4200-0250	NUT: FINISHING,1/4-20,HEX,SS	4	600
Flat Washer for 4500-1351	4600-0300	WASHER: FLAT,1/4,USS,BLK OX (3/4" OD)	4	600
Front Door				
Glass Clip Screws	4500-1874	SCREW: MACH,10-24x1/4",PAN,PH,BLK OX	8	400
Front Door Hinge Pins	4400-0300	RIVET: 3/16x1-3/8",ROUND,STEEL,BLK ZN	2	600
Washer for 4400-0300	4600-1210	WASHER: FLAT,10,SAE, BLACK OXIDE	2	400
Side Door				
Side Door Stone Retainer	4500-1910	SCREW: MACH,10-24x1/2",FLAT,PH,BLK OX	4	400
Side Door Hinge Pins	4400-0300	RIVET: 3/16x1-3/8",ROUND,STEEL,BLK ZN	2	600
Flat Washer for 4400-0300	4600-1210	WASHER: FLAT,10,SAE, BLACK OXIDE	2	400
Second. Plen.				
Top to Bottom, Front Holes	4500-0560	SCREW: MACH,1/4-20x1/2",FLAT,PH,BLK OX	2	400
Top to Bottom, Rear Holes	4500-1300	SCREW: MACH,1/4-20x1-1/4",FLAT,PH,BLK	2	600

※廃番機種のパーツは、主要パーツ以外、在庫がなくなり次第終了となる可能性があります。

	機種 (モデル)	製造 (Serial No.)	サイドドア
クリーンバーン	ヘリテージ 8020	1997/11-2003/01 (5001-11080)	左のみ (前後開閉式)
クリーンバーン	ヘリテージ 8021	2003/02-2014/05 (1001-32000)	左のみ (前後開閉式)
クリーンバーン	ヘリテージ 8022	2014/05-2017/04 (35000-39000)	左右 (上下開閉式)
クリーンバーン	ヘリテージ 8023	2017/04-2019/08 (40000-43000)	左右 (上下開閉式)
ハイブリッド	ヘリテージ 8024	2020/02- (50001-)	左右 (上下開閉式)